

DATE PLOTTED: 7 September 2016 9:10 AM BY: DANIEL GRIFFITHS
XREFs: XR-CG150547-CI-TITLE.BLOCK; XR-CG150545-CI-EX.CONTOURS; XR-CG150545-CI-F&L SURVEY; XR-CG150545-CI-FUTURE; XR-CG150547-CI-HATCH; XR-CG150547-CI-ELEMENTS; XR-CG150547-CI-TABLE; XR-V161888C-CI-BASE
CAD File: O:\DRAC\WIL2015\CG150547 - Hobbs Road Stage 2\CG150547-CI-1050.dwg

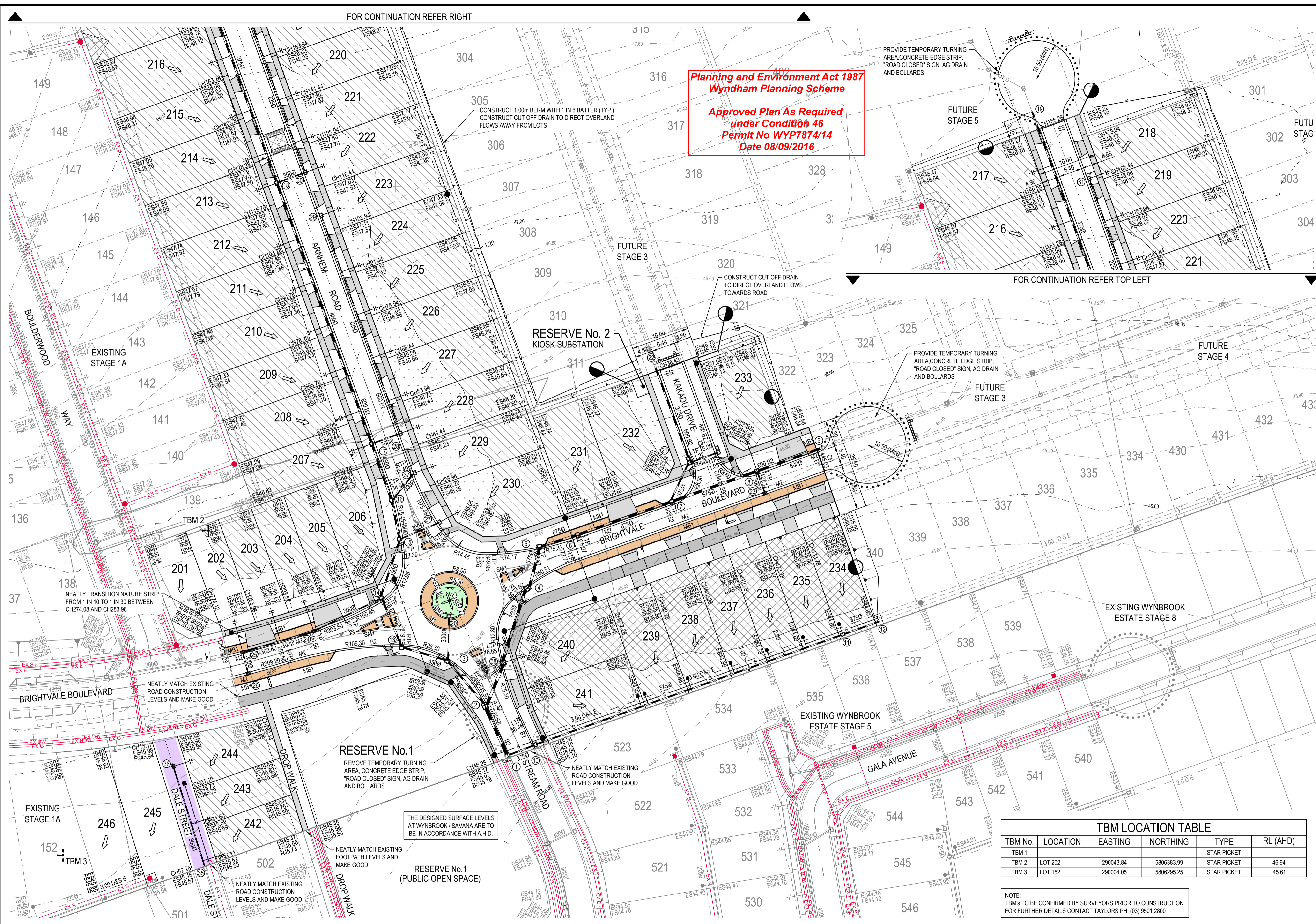

**Planning and Environment Act 1987
Wyndham Planning Scheme**
**Approved Plan As Required
under Condition 46
Permit No WYP7874/14
Date 08/09/2016**

LEGEND	
	PERMANENT SURVEY MARK
	TEMPORARY BENCH MARK
	EXISTING SURFACE CONTOUR - MAJOR
	EXISTING SURFACE CONTOUR - MINOR
	FALL OF ALLOTMENT
	CENTRELINE OF ROAD
	EXISTING SURFACE LEVELS
	FINISHED SURFACE LEVELS
	BATTER SURFACE LEVELS
	RIDGE LEVELS
	KERB AND CHANNEL (AS SHOWN)
	PROPOSED RETAINING WALL
	VEHICLE EXCLUSION FENCE (BY OTHERS)
	PROPOSED ZERO LOT LINE
	STAGE BOUNDARY
	PROPOSED BATTER
	EXISTING TREE
	EXISTING TREE TO BE REMOVED
	EXISTING FEATURES TO BE REMOVED
	DIRECTION
	TACTILE GROUND SURFACE INDICATORS
	PROPOSED INDUSTRIAL VEHICLE CROSSING
	PROPOSED RESIDENTIAL VEHICLE CROSSING
	LIMIT OF WORKS
	"NO ROAD" SIGN AND BARRIER
	PROPOSED TRAFFIC SIGN
	PROPOSED STREET SIGN
	LINE MARKING AND RRPMS
	PROPOSED STORMWATER DRAIN, PIT, DIAMETER AND PROPERTY INLET
	EXISTING STORMWATER DRAIN, PIT, DIAMETER AND PROPERTY INLET
	PROPOSED MAIN DRAIN, PIT AND DIAMETER
	EXISTING MAIN DRAIN, PIT AND DIAMETER
	PROPOSED AGRICULTURAL DRAIN
	PIT NUMBER
	PROPOSED SWALE DRAIN
	OFFSET FROM BUILDING LINE
	PROPOSED SEWER, MAINT. STRUCTURES
	EXISTING SEWER, MAINT. STRUCTURES
	PROPOSED RISING MAIN
	EXISTING RISING MAIN
	EXISTING WATER
	EXISTING GAS
	EXISTING ELECTRICITY
	EXISTING TELECOMMUNICATION
	EXISTING RISING MAIN
	EXISTING DRINKING WATER
	EXISTING NON-DRINKING WATER
	EXISTING WATER AND GAS CONDUIT
	EXISTING IRRIGATION CONDUIT
	GARBAGE COLLECTION POINT
	VEHICLE CROSSING AND FOOTPATH, 1.50 m WIDE
	SHARED PATH, 3.00 m WIDE
	CONCRETE INFILL
	DALE STREET CONCRETE PAVEMENT
	LANDSCAPING (BY OTHERS)
	LOT GRADING (CUT)
	LOT GRADING (FILL LESS THAN 300mm DEEP)
	LOT GRADING (FILL GREATER THAN 300mm DEEP)

WARNING
HIGH PRESSURE GAS MAINS IN CLOSE PROXIMITY

WARNING
BE AWARE OF UNDERGROUND SERVICES
THE LOCATION OF UNDERGROUND SERVICES ARE APPROXIMATE ONLY AND THEIR EXACT POSITION SHOULD BE PROVEN ON SITE. NO GUARANTEE IS GIVEN THAT ALL EXISTING SERVICES ARE SHOWN.

TBM No.	LOCATION	EASTING	NORTHING	TYPE	RL (AHD)
TBM 1	LOT 202	290043.84	5806383.99	STAR PICKET	46.94
TBM 2	LOT 152	290004.05	5806295.25	STAR PICKET	45.61

NOTE:
TBMs TO BE CONFIRMED BY SURVEYORS PRIOR TO CONSTRUCTION.
FOR FURTHER DETAILS CONTACT TAYLORS PH: (03) 9501 2800

COUNCIL REFERENCE
WYP7871/14.02

Rev.	Date	Description	Des.	Verif.	Appd.
A	07/09/2016	CONSTRUCTION ISSUE	M.S.	S.C.	N.G.



savana

© Cardno Limited All Rights Reserved.
This document is produced by Cardno Limited solely for the benefit of and use by the client in accordance with the terms of the retainer. Cardno Limited does not and shall not assume any responsibility or liability whatsoever to any third party arising out of any use or reliance by third party on the content of this document.

Cardno
Shaping the Future

Cardno Victoria Pty Ltd | ABN 47 106 610 913
Level 4, 501 Swanston Street
Melbourne VIC 3000
Tel: 03 8415 7777 Fax: 03 8415 7788
Web: www.cardno.com.au

Drawn	Date	Client AVID PROPERTY GROUP Project SAVANA - STAGE 2 50 HOBBS ROAD, WYNDHAM VALE WYNDHAM CITY COUNCIL Title CIVIL SITEWORKS DETAIL PLAN
J.D.	18/07/2016	
Checked	Date	
N.W.	20/07/2016	
Designed	Date	
M.S.	15/07/2016	
Verified	Date	
S.C.	07/09/2016	
Approved	Date	
N.GLASSON	07/09/2016	

Status	FOR CONSTRUCTION		
Datum	Melways Ref	Scale	Size
AHD	233 H10	1:500	A1
Drawing Number	CG150547-CI-1050		Revision
			A